

# EXISTING TREE INVENTORY

TAG #	TREE NAME	T/DB	#STEMS	COMB DBH (IN. ROUNDED)	CONDITION	EXCEPTIONAL PER MICC
1	Acer macrophyllum (Bigleaf maple)	D	1	27	4	NO
2	Pseudotsuga menziesii (Douglas fir)	E	1	24	4	NO
3	Pseudotsuga menziesii (Douglas fir)	E	1	15	3	NO
4	Acer macrophyllum (Bigleaf maple)	D	1	14	5	NO
5	Pinus nigra (Austrian pine)	E	1	19	3	YES
6	Pinus nigra (Austrian pine)	E	1	33	3	YES
7	Pinus nigra (Austrian pine)	E	1	29	4	YES
8	Pinus nigra (Austrian pine)	E	1	28	4	YES
9	Pinus nigra (Austrian pine)	E	1	31	3	NO
10	Acer macrophyllum (Bigleaf maple)	D	1	11	4	NO
11	Acer macrophyllum (Bigleaf maple)	D	1	13	3	NO
12	Thuja plicata (Western red cedar)	E	1	11	3	NO
13	Thuja plicata (Western red cedar)	E	1	14	3	NO
14	Thuja plicata (Western red cedar)	E	1	43	3	YES
15	Acer macrophyllum (Bigleaf maple)	D	1	22	3	NO
16	Alnus rubra (Red alder)	D	1	20	4	NO
17	Thuja plicata (Western red cedar)	E	1	12	3	NO
18	Acer macrophyllum (Bigleaf maple)	D	1	13	4	NO
19	Thuja plicata (Western red cedar)	E	1	11	3	NO
20	Acer macrophyllum (Bigleaf maple)	D	1	38	3	YES
21	Acer macrophyllum (Bigleaf maple)	D	1	33	4	YES
22	Arbutus menziesii (Pacific madrone)	E	1	11	2	YES
25	Picea abies (Norway spruce)	E	1	14	4	NO
27	Acer macrophyllum (Bigleaf maple)	D	1	16	5	NO
28	Acer macrophyllum (Bigleaf maple)	D	10	13	5	NO
29	Acer macrophyllum (Bigleaf maple)	D	10	13	5	NO
30	Acer macrophyllum (Bigleaf maple)	D	10	13	5	NO
31	Acer macrophyllum (Bigleaf maple)	D	10	13	5	NO
32	Acer macrophyllum (Bigleaf maple)	D	10	13	5	NO
33	Thuja plicata (Western red cedar)	E	1	10	5	NO
34	Thuja plicata (Western red cedar)	E	2	14	5	NO
35	Pinus nigra (Austrian pine)	E	1	14	5	NO
36	Acer macrophyllum (Bigleaf maple)	D	5	13	3	NO
37	Thuja plicata (Western red cedar)	E	1	12	5	NO
38	Thuja plicata (Western red cedar)	E	1	12	5	NO
39	Thuja plicata (Western red cedar)	E	1	12	5	NO
40	Thuja plicata (Western red cedar)	E	1	12	5	NO
41	Thuja plicata (Western red cedar)	E	1	14	5	NO
42	Thuja plicata (Western red cedar)	E	1	14	5	NO
43	Thuja plicata (Western red cedar)	E	1	16	5	NO

TAG #	TREE NAME	T/DB	#STEMS	COMB DBH (IN. ROUNDED)	CONDITION	EXCEPTIONAL PER MICC
2801	Pinus nigra (Austrian pine)	E	1	18	3	NO
2802	Populus balsamifera (Black cottonwood)	D	1	43	4	YES
2803	Pinus nigra (Austrian pine)	E	1	12	3	NO
2804	Pinus nigra (Austrian pine)	E	1	11	3	NO
2805	Pinus nigra (Austrian pine)	E	1	10	3	NO
2806	Acer macrophyllum (Bigleaf maple)	D	2	22	3	NO
2807	Acer macrophyllum (Bigleaf maple)	D	2	23	4	NO
2808	Robinia pseudoacacia (Black locust)	D	1	13	4	NO
2809	Pinus nigra (Austrian pine)	E	1	10	4	NO
2811	Acer macrophyllum (Bigleaf maple)	D	2	28	5	NO
2812	Acer macrophyllum (Bigleaf maple)	D	1	10	4	NO
2813	Thuja plicata (Western red cedar)	E	1	21	3	NO
2814	Acer macrophyllum (Bigleaf maple)	D	1	10	4	NO
2815	Acer macrophyllum (Bigleaf maple)	D	1	10	3	NO
2816	Thuja plicata (Western red cedar)	E	1	29	3	NO
2819	Alnus rubra (Red alder)	D	1	11	3	NO
2820	Acer macrophyllum (Bigleaf maple)	D	1	12	3	NO
2821	Thuja plicata (Western red cedar)	E	1	15	3	NO
2822	Acer macrophyllum (Bigleaf maple)	D	2	13	4	NO
2824	Acer macrophyllum (Bigleaf maple)	D	1	18	4	NO
2825	Thuja plicata (Western red cedar)	E	1	16	3	NO
2826	Thuja plicata (Western red cedar)	E	1	14	3	NO
2827	Thuja plicata (Western red cedar)	E	1	10	3	NO
2828	Thuja plicata (Western red cedar)	E	1	24	3	NO
2829	Thuja plicata (Western red cedar)	E	1	13	3	NO
2830	Thuja plicata (Western red cedar)	E	1	19	4	NO
2831	Fraxinus sp. (Ash species)	D	3	15	4	NO
2832	Thuja plicata (Western red cedar)	E	1	14	4	NO
2834	Pinus nigra (Austrian pine)	E	1	13	3	NO
2835	Pinus nigra (Austrian pine)	E	1	17	3	NO
2836	Pinus nigra (Austrian pine)	E	1	10	3	NO
2837	Pinus nigra (Austrian pine)	E	1	14	3	NO
2838	Pinus nigra (Austrian pine)	E	1	17	3	NO
2840	Pinus nigra (Austrian pine)	E	1	10	4	NO
2841	Pinus nigra (Austrian pine)	E	1	17	3	NO
2842	Pinus nigra (Austrian pine)	E	1	12	3	NO
2843	Acer macrophyllum (Bigleaf maple)	D	1	10	4	NO
2844	Acer macrophyllum (Bigleaf maple)	D	1	10	5	NO
2845	Pinus nigra (Austrian pine)	E	1	11	3	NO
2846	Pinus nigra (Austrian pine)	E	1	17	3	NO

TAG #	TREE NAME	T/DB	#STEMS	COMB DBH (IN. ROUNDED)	CONDITION	EXCEPTIONAL PER MICC
2847	Pinus nigra (Austrian pine)	E	1	11	3	NO
2849	Pinus nigra (Austrian pine)	E	1	13	4	NO
2850	Pinus nigra (Austrian pine)	E	1	20	3	NO
2852	Pseudotsuga menziesii (Douglas fir)	E	1	10	3	NO
2853	Thuja plicata (Western red cedar)	E	1	17	4	NO
2854	Arbutus menziesii (Pacific madrone)	E	1	12	5	YES
2855	Acer macrophyllum (Bigleaf maple)	D	5	37	3	YES
2856	Thuja plicata (Western red cedar)	E	1	11	3	NO
2857	Arbutus menziesii (Pacific madrone)	E	1	6	2	YES
2858	Prunus emarginata (Bitter cherry)	D	1	14	4	NO
2859	Acer macrophyllum (Bigleaf maple)	D	7	28	5	YES
2861	Pseudotsuga menziesii (Douglas fir)	E	1	27	3	NO
2862	Pinus nigra (Austrian pine)	E	1	18	5	NO
2863	Thuja plicata (Western red cedar)	E	1	10	4	NO
2864	Thuja plicata (Western red cedar)	E	1	12	3	NO
2865	Thuja plicata (Western red cedar)	E	1	25	3	NO
2866	Thuja plicata (Western red cedar)	E	2	15	4	NO
2867	Thuja plicata (Western red cedar)	E	1	12	3	NO
2868	Pseudotsuga menziesii (Douglas fir)	E	1	49	3	YES
2869	Pseudotsuga menziesii (Douglas fir)	E	1	41	3	YES
2870	Thuja plicata (Western red cedar)	E	1	11	2	NO
2871	Alnus rubra (Red alder)	D	2	12	3	NO
2872	Pseudotsuga menziesii (Douglas fir)	E	1	34	2	YES
2873	Arbutus menziesii (Pacific madrone)	E	1	12	4	YES
2874	Arbutus menziesii (Pacific madrone)	E	1	17	5	YES
2875	Pseudotsuga menziesii (Douglas fir)	E	1	29	3	NO
2876	Arbutus menziesii (Pacific madrone)	E	1	14	5	YES
2877	Thuja plicata (Western red cedar)	E	1	14	2	NO
2878	Thuja plicata (Western red cedar)	E	1	17	2	NO
2879	Pseudotsuga menziesii (Douglas fir)	E	1	29	2	NO
2880	Pseudotsuga menziesii (Douglas fir)	E	1	24	2	NO
2881	Pseudotsuga menziesii (Douglas fir)	E	1	24	3	NO
2882	Acer macrophyllum (Bigleaf maple)	D	1	11	5	NO
2883	Acer macrophyllum (Bigleaf maple)	D	1	15	5	NO
2884	Pseudotsuga menziesii (Douglas fir)	E	1	39	3	YES
2885	Pseudotsuga menziesii (Douglas fir)	E	1	27	3	NO
2886	Pseudotsuga menziesii (Douglas fir)	E	1	41	3	YES
2887	Pseudotsuga menziesii (Douglas fir)	E	1	22	4	NO
2888	Acer macrophyllum (Bigleaf maple)	D	1	33	3	YES
2889	Thuja plicata (Western red cedar)	E	1	18	4	NO

TAG #	TREE NAME	T/DB	#STEMS	COMB DBH (IN. ROUNDED)	CONDITION	EXCEPTIONAL PER MICC	
2890	Pseudotsuga menziesii (Douglas fir)	E	1	43	3	YES	
2891	Pseudotsuga menziesii (Douglas fir)	E	1	26	3	NO	
2892	Pseudotsuga menziesii (Douglas fir)	E	1	34	3	YES	
2893	Thuja plicata (Western red cedar)	E	1	19	4	NO	
2894	Thuja plicata (Western red cedar)	E	1	14	4	NO	
2895	Pseudotsuga menziesii (Douglas fir)	E	1	19	3	NO	
2896	Pinus nigra (Austrian pine)	E	1	17	3	NO	
2897	Tsuga heterophylla (Western hemlock)	E	1	11	4	NO	
2898	Thuja plicata (Western red cedar)	E	4	19	4	NO	
2899	Thuja plicata (Western red cedar)	E	1	17	4	NO	
2900	Thuja plicata (Western red cedar)	E	1	22	4	NO	
2903	Arbutus unedo (Strawberry tree)	E	1	20	24	3	NO

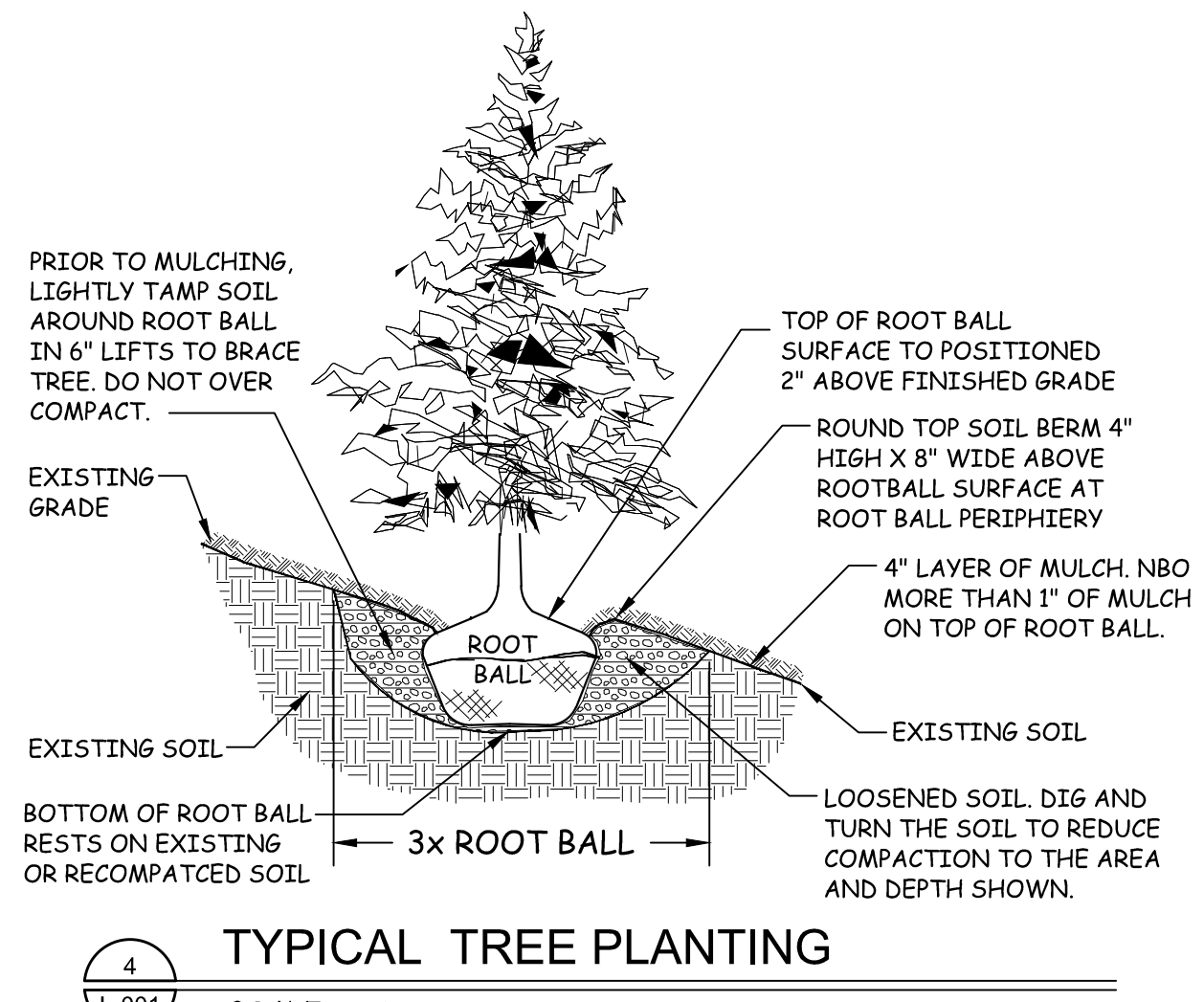

# TREES TO BE REMOVED

Tree ID	Scientific Name	DBH (in.)	Condition	Reason for Removal	Replacement Ratio (X:1)
23	Malus domestica	8	3- Fair	Driveway construction	1.0
28	Acer macrophyllum	13*	5- Dead or dying	Driveway construction	1.0
29	Acer macrophyllum	13*	5- Dead or dying	Driveway construction	1.0
30	Acer macrophyllum	13*	5- Dead or dying	Driveway construction	1.0
31	Acer macrophyllum	13*	5- Dead or dying	Driveway construction	1.0
32	Acer macrophyllum	13*	5- Dead or dying	Driveway construction	1.0
2803	Pinus nigra	12	3- Fair	Accessory structure construction	1.0
2804	Pinus nigra	11	3- Fair	Accessory structure construction	1.0
2805	Pinus nigra	10	3- Fair	Accessory structure construction	1.0
2807	Acer macrophyllum	23	4- Poor	Accessory structure construction	2.0
2808	Robinia pseudoacacia	13	4- Poor	Accessory structure construction	2.0
2891	Pseudotsuga menziesii	26	3- Fair	Residence construction	3.0
2896	Pinus nigra	17	3- Fair	Residence construction	1.0
2904	Acer palmatum	9	3- Fair	driveway construction	1.0

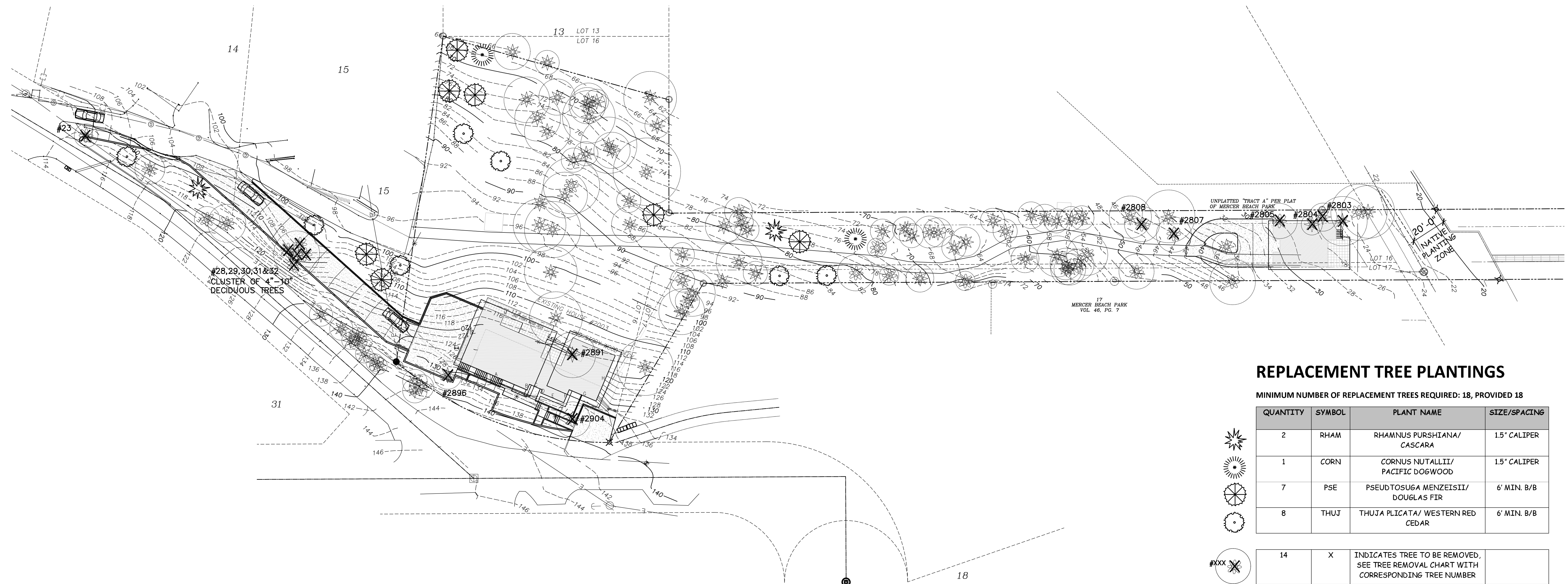

# 1 TREE REPLACEMENT PLAN

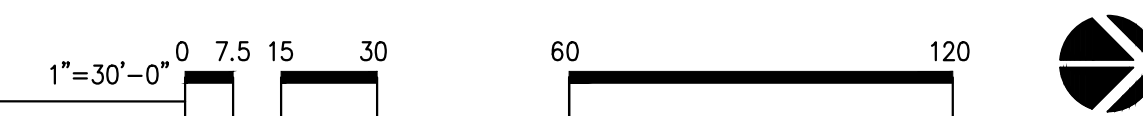

# REPLACEMENT TREE PLANTINGS

MINIMUM NUMBER OF REPLACEMENT TREES REQUIRED: 18, PROVIDED 18

QUANTITY	SYMBOL	PLANT NAME	SIZE/SPACING
2	RHAM	RHAMNUS PURSHIANA/ CASCARA	1.5" CALIPER
1	CORN	CORNUS NUTALLII/ PACIFIC DOGWOOD	1.5" CALIPER
7	PSE	PSEUDOTSUGA MENZEISII/ DOUGLAS FIR	6' MIN. B/B
8	THUJ	THUJA PLICATA/ WESTERN RED CEDAR	6' MIN. B/B
14	X	INDICATES TREE TO BE REMOVED, SEE TREE REMOVAL CHART WITH CORRESPONDING TREE NUMBER	

**KEN LARGE**  
Landscape Architect  
21803 NE 17th Court  
Sammamish, WA 98074  
Office: 425-836-4578, Cell: 206-396-7617  
E-mail: klarge@comcast.net  
FAX: 425-898-8923

SEAL:  
STATE OF WASHINGTON  
REGISTERED  
LANDSCAPE ARCHITECT  
**Ken Large**  
KENNETH E. LARGE  
CLASS. NO. 10000  
EXPIRES 12/31/2018  
CERTIFICATE #001

**PHILLIPS RESIDENCE**  
2003 82ND AVE  
MERCER ISLAND, WA.

JOB NUMBER: \_\_\_\_\_  
DRAWN: \_\_\_\_\_ KEL  
CHECKED: \_\_\_\_\_  
DATE: MAY 01, 2019  
REVISIONS:  
1

SHEET TITLE:  
**TREE REPLACEMENT PLAN**  
PERMIT SET  
SHEET NUMBER:

**L001**